

16+2+1SFP Gigabit PoE switch

Standard PoE power supply 2* uplink port

Product Specification Ver2.0

IG-SG1816PX



- 16*10/100/1000Base-TX Ethernet ports (PoE ports)
- 2*10/100/1000Base-TX+1*1.25G SFP uplink port
- Power adapter: 52V2.4A 125W (built-in power supply)
- Single port $\leq 30W$, Total $\leq 260W$
- Dual uplink port design, flexible and compatible.
- Plug and play, no setup required
- Status indicator function, easy maintenance
- Desktop, Wall-mounted

Product Description

This switch is a 19-port gigabit unmanaged PoE switch, specially designed for million-high-definition network monitoring, network engineering and other security monitoring systems. It can provide seamless data connection for 10/100/1000Mbps Ethernet, and also has PoE power supply function, which can power power-receiving devices such as network surveillance cameras and wireless (AP) devices.

There are 16 10/100/1000Mbps downlink power ports, 2 10/100/1000 MBPS uplink power ports, and 1 1.25G SFP port. Among them, the gigabit downlink ports 1 to 16 all support 802.3af/at standard PoE power supply, and the maximum output power of a single port is 30W. The maximum PoE output power of the entire machine is 260W. The design of dual gigabit uplink ports and one SFP port can meet the connection requirements of local NVR storage and aggregation switches or external network devices. The unique system mode selection switch design of the switch allows users to select the preset working mode according to the actual situation of the network application, thereby adapting to the ever-changing network environment. It is highly suitable for hotels, campuses, factory dormitories and small and medium-sized enterprises to establish economical and efficient networks.

Applications

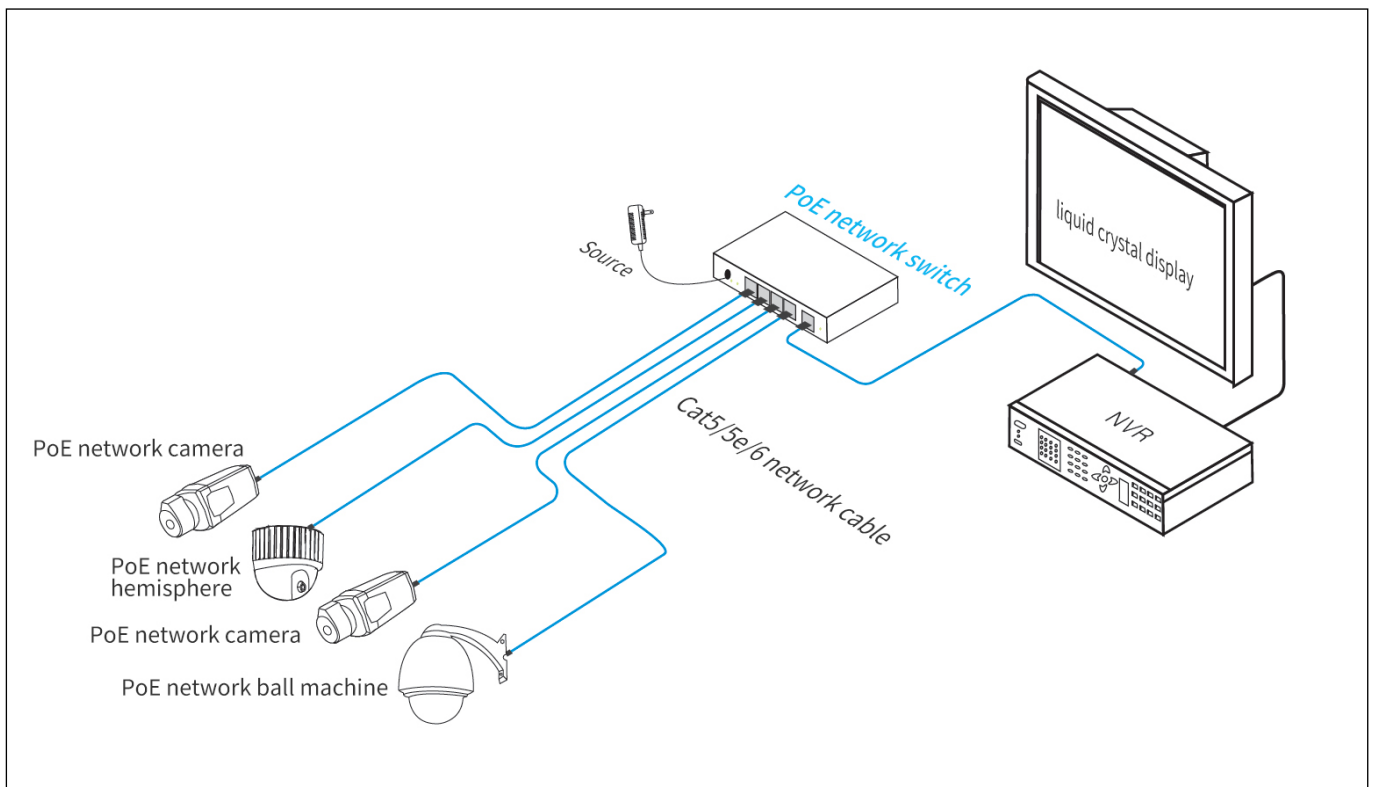

Specifications

Model	IG-SG1816PX	
Port Features	PoE port	16*10/100/1000Base-TX Ethernet ports (PoE)
	Uplink port	2*10/100/1000Base-TX Ethernet ports, 1*1.25G SFP port
PoE Features	PoE Standards	IEEE802.3af; IEEE802.3at
	PoE power supply mode	Standard DC52V power supply: default 1/2(+), 3/6(-)
	PoE Output Power	Single-port PoE output ≤30W (52V DC); PoE output power of the whole device ≤260W
Switching performance	Web Standards	IEEE802.3; IEEE802.3u; IEEE802.3x
	Switching capacity	32Gbps
	Packet forwarding rate	26.784Mpps
	Exchange method	Store and forward (full line speed)
Protection level	Lightning protection	4KV 8/20us
	Protection level	IP40
DIP switch	OFF	The rate of ports 1-8 is 1000Mbps and the transmission distance is 100 meters.
	ON	The rate of ports 1-8 is 10Mbps and the transmission distance is 250 meters.
Power Specifications	Input voltage	AC 110-260V 50-60Hz
	Output Power	DC 52V5A
	Power consumption	Standby power consumption: ≤4W; Full load power consumption: ≤260W
LED Indicator	Power Indicator	1*PWR, Power Indicator
	Network port	10*Link/Act
Environmental characteristics	Operating temperature	-20°C ~ +60°C
	Storage temperature	-30°C ~ +75°C
	Working humidity	5%-95% (No condensation)
External structure	Product Size	(Length × Depth × Height) : 270*205*44mm
	Installation	Desktop, wall-mounted

Packing List

Name	QTY
16+2+1SFP Gigabit PoE Switch	1pc
AC power cable	1pc
User Manual	1pc
Product certificate (Warranty card)	1pc

Related Products

Name	Model
16+2+1SFP Gigabit PoE Switch	IG-SG1816PX