

8+2 100M PoE switch

Standard PoE power supply 2* uplink port

Product Specification Ver2.0

IG-SF1008P



- 8 lower 10/100 base-TX Ethernet ports (PoE ports)
- Two uplink 10/100 BASE-TX Ethernet uplink ports
- Power adapter: 52V2.4A 125W(Built-in power supply)
- The maximum output power of a single port is 30W, and the total power of the entire machine is 125W
- Dual upper connection ports facilitate flexible networking for users and meet the networking requirements of various scenarios.
- Plug and play, no Settings required, simple and convenient to use
- The perfect status indication function is convenient for maintenance and management.
- Desktop installation

Product Description

This switch is a 10-port 100-megabit unmanaged PoE switch, specially designed for million-high-definition network monitoring, network engineering and other security monitoring systems. It can provide seamless data connection for 10/100Mbps Ethernet and also has PoE power supply function, which can power power-receiving devices such as network surveillance cameras and wireless (AP) devices.

It features 8 10/100Mbps downlink ports and 2 10/100Mbps uplink ports. Among them, ports 1 to 8 all support 802.3af/at standard PoE power supply. The maximum output power of a single port is 30W, and the maximum PoE output power of the entire machine is 125W. It is designed with dual 100Mbps uplink ports. It can meet the connection requirements of local NVR storage and aggregation switches or external network devices. The unique system mode selection switch design of the switch allows users to select the preset working mode according to the actual situation of the network application, thereby adapting to the ever-changing network environment. It is highly suitable for hotels, campuses, factory dormitories and small and medium-sized enterprises to establish economical and efficient networks.

Applications

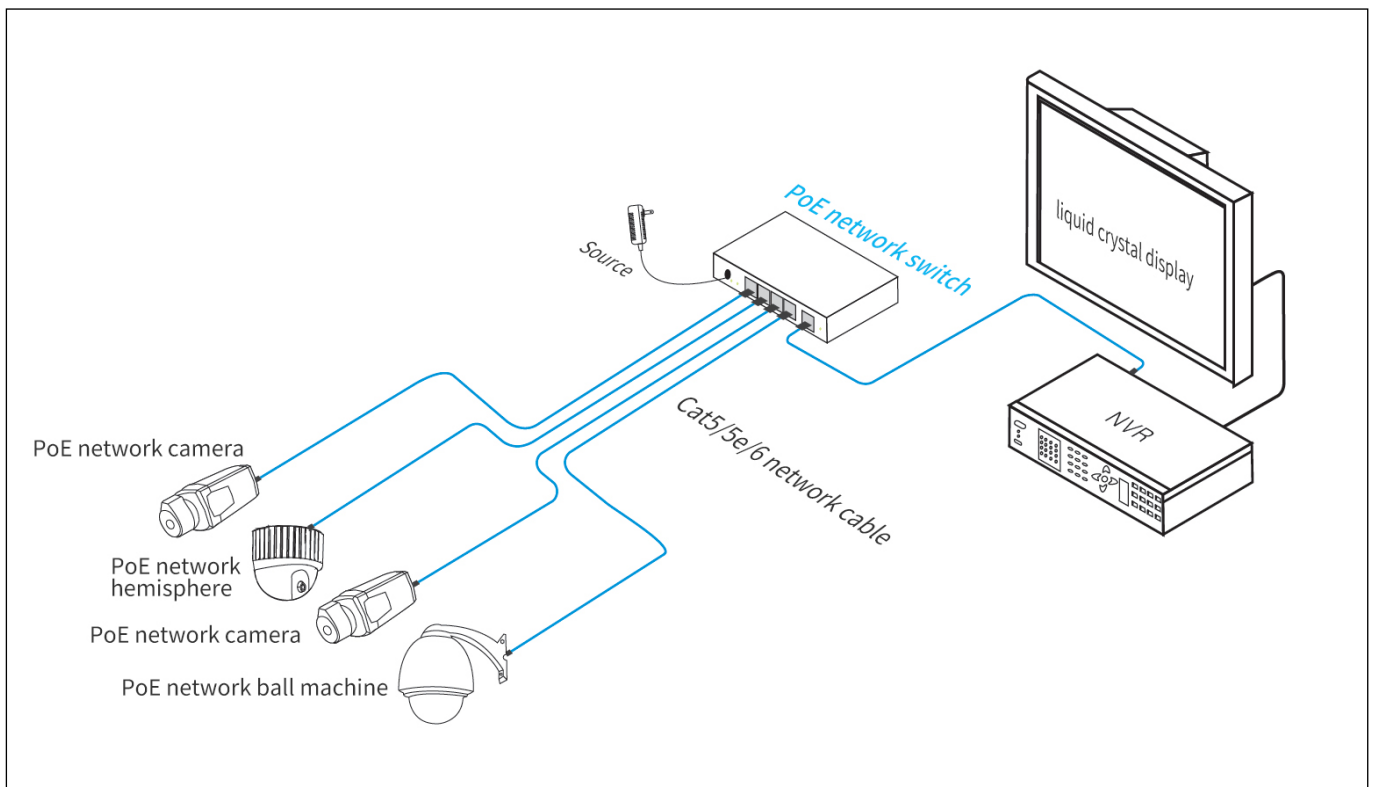

Specifications

Model	IG-SF1008P	
Port Features	PoE port	8*10/100Base-TX Ethernet ports (PoE)
	Uplink port	Two 10/100 base-TX Ethernet ports
PoE Features	PoE Standards	IEEE802.3af; IEEE802.3at
	PoE power supply mode	Standard DC52V power supply: default 1/2(+), 3/6(-)
	PoE Output Power	Single-port PoE output ≤30W (52V DC); PoE output power of the whole device ≤ 125W
Switching performance	Web Standards	IEEE802.3; IEEE802.3u; IEEE802.3x
	Switching capacity	2Gbps
	Packet forwarding rate	1.488Mpps
	Exchange method	Store and forward (full line speed)
Protection level	Lightning protection	4KV 8/20us
	Protection level	IP40
DIP switch	OFF	The rate of ports 1-8 is 1000Mbps and the transmission distance is 100 meters.
	ON	The rate of ports 1-8 is 10Mbps and the transmission distance is 250 meters.
Power Specifications	Input voltage	AC 110-260V 50-60Hz
	Output Power	DC 52V 2.4A
	Power consumption	Standby power consumption: ≤4W; Full load power consumption: ≤125W
LED Indicator	Power Indicator	1*PWR, Power Indicator
	Network port	10*Link/Act
Environmental characteristics	Operating temperature	-20°C ~ +60°C
	Storage temperature	-30°C ~ +75°C
	Working humidity	5%-95% (No condensation)
External structure	Product Size	(Length × Depth × Height) : 195*130*40mm
	Installation	Desktop, wall-mounted

Packing List

Name	QTY
8+2 100M PoE Switch	1pc
AC power cable	1pc
User Manual	1pc
Product certificate (Warranty card)	1pc

Related Products

Name	Model
8+2 100M PoE Switch	IG-SF1008P